

EarthWay Garden

ASSEMBLY and OPERATING INSTRUCTIONS
for *EarthWay*
MODEL 6500
High Wheel Cultivators

HELPFUL HINTS: READ DIRECTIONS BEFORE ASSEMBLY AND ENSURE ALL PARTS ARE ACCOUNTED FOR. IF STILL HAVING TROUBLE ASSEMBLING YOU CAN CALL 574-848-7491 OR 800-294-0671 FOR ASSISTANCE.

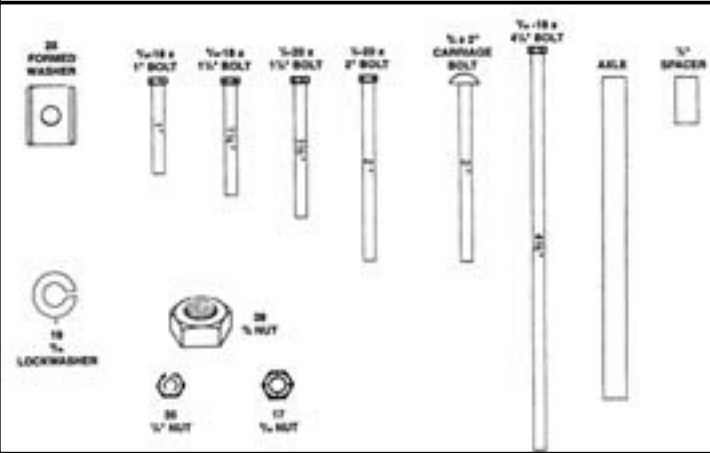

Your High Wheel Cultivator is intended for use in soil already plowed or tilled. It is not designed as a ground breaking tool.

1. Remove and identify all loose parts from carton.
2. Put handle grips (9) on round end of upper handles (4)
3. Insert Axle bolt (18) through hole in flat end of one of the lower handles (5). Next insert the bolt through the hole in the straight end of frame (8). Place axle (26) into center of wheel (1). Now put axle bolt through the axle, then put other frame (8) and flat end of other lower handle over axle bolt and fasten with lock washer (19) and hex nut (17).
4. Insert bolt (37) through hole in bottom of right tool support (6). Now put spacer (10) and left tool support (7) over bolt and fasten with hex nut (17).
5. Put tool support assembly from Step 4 between frame ends (8) with spacer end down and curve toward wheel. Now fasten frame to tool support assembly with bolt (15) and hex nut (35).
6. Now take upper handles (4) and attach to lower handles (5) using bolt (30) and hex nut (17). Note: You may want to adjust the height of the handle before using for easier operating. To adjust height, simply move bolt (30) to higher or lower position on tool supports (6) and (7).
7. Now install the cross brace (2) to upper handles (4). Take bolt (14) and put bolt through hole in cross brace then through upper handle (4). Fasten with hex nut (35). Repeat on other side.

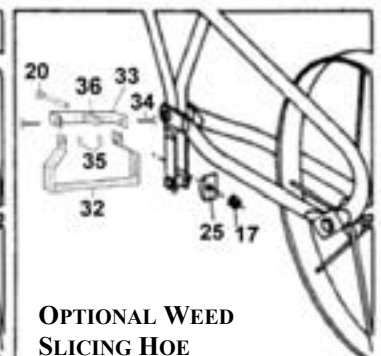
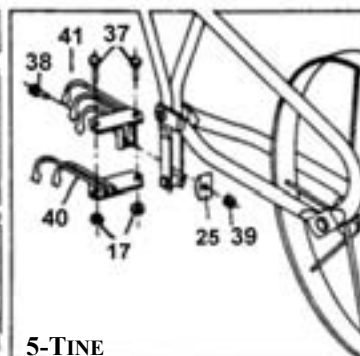
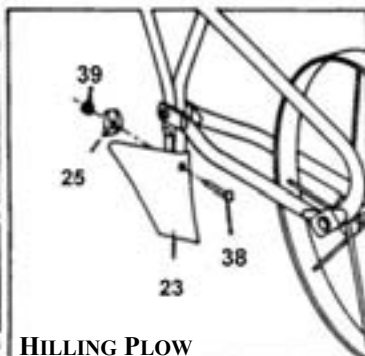
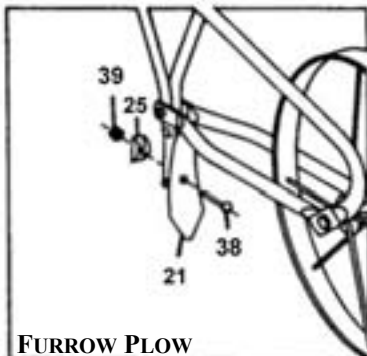

ASSEMBLY OF TOOLS (see above)

FURROW PLOW

Place Furrow Plow (21) in front of tool support slot. Put carriage bolt (38) through square hole and through slot in tool support. Next put formed washer (25) over carriage bolt (38) and tool support then fasten with lock nut (39).

HILLING PLOW

Place Hilling Plow in position shown above. Follow instructions from above.

FIVE TINE

Assemble 5-Tine as pictured above and fasten with two (37) and two (17) hex nuts. Next put carriage bolt (38) through rear of the assembly and through tool support, fasten with formed washer (25) and lock nut (39).

PLEASE CALL IF YOU ARE MISSING ANY PARTS, HAVE DIFFICULTY IN ASSEMBLY, OR HAVE ANY QUESTIONS REGARDING THE SAFE OPERATION OF THIS PRODUCT.
SUPPORT HOT LINE: 574-848-7491 OR 800-294-0671
EMAIL: TECHSUPPORT@EARTHWAY.COM

EarthWay®

Products, Inc.

P.O. Box 547
 Bristol, Indiana 46507
 (574) 848-7491
 www.earthway.com

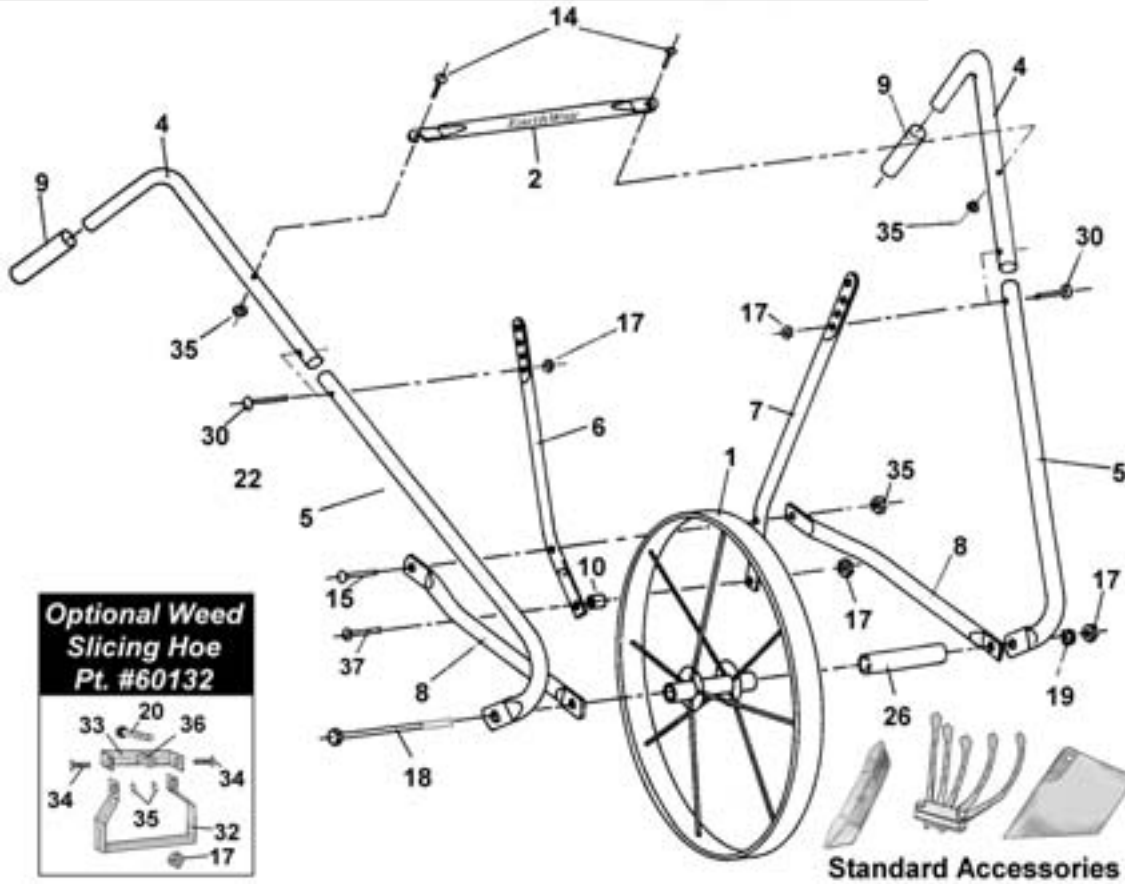

6500 High Wheel Cultivator

Key #	Part #	Description	Key #	Part #	Description	Key #	Part #	Description
1	60130	Wheel	17	32102	* 5/16-18 Hex Nut	32	44244	<i>Optional</i> Slicing Hoe Blade
2	23604	Cross Brace	18	31116	* 5/16-18 X 4 1/2" Hex Bolt	33	44252	<i>Optional</i> Slicing Hoe Bracket
4	23401	Upper Handle	19	34104	* 5/16 Split Lock Washer	34	31101	<i>Optional</i> 1/4-20 X 3/4" Hex Bolt
5	23204	Lower Handle	20	31125	* 5/16-18 X 2" Hex Bolt	35	32103	<i>Optional</i> 1/4-20 Nylon Locknut
6	23601	Right Tool Support	21	44227	Furrow Plow	36	44253	<i>Optional</i> Tool Adapter
7	23602	Left Tool Support	22	60141	5-Tine Assembly, Includes Key 40 & 41	37	31111	* 5/16-18 X 1" Hex Bolt
8	23104	Frame	23	44228	Hilling Plow (Mold Board Plow)	38	37105	* 3/8-16 X 2" Carriage Bolt
9	19111	Handle Grip	24	60132	<i>Optional</i> Slicing Hoe Assembly	39	32109	* 3/8-16 Hex Nut
10	23605	Tool Support Spacer	25	43033	Formed Washer	40	60138	Two Tine Assembly
14	31100	* 1/4-20 X 1 1/2" Hex Bolt	26	23500	Axle	41	60139	Three Tine Assembly
15	31120	* 1/4-20 X 2" Hex Bolt	30	31115	* 5/16-18 X 1 1/2" Hex Bolt			

5-YEAR LIMITED WARRANTY

EarthWay Products, Inc. warrants this product to be free of defects in original workmanship and materials for a period of 5-Years to the end user with the original purchase receipt. If a manufacturing non-conformance is found, EarthWay Products, Inc. at its discretion will repair or replace the part(s) or product at no charge provided the failure is not the result of incorrect installation, mishandling, misuse, tampering, or normal wear and tear as determined by EarthWay. EarthWay at its discretion may require that the part(s) or product be returned along with the original purchase receipt at owners' expense for examination and compliance with the terms of this warranty. (Do not return any product without first receiving authorization from EarthWay Products, Inc.). To seek remedy under this warranty, contact EarthWay Products, Inc. at 574-848-7491, techsupport@earthway.com or write to (EarthWay Products, Inc. P.O. Box 547 Bristol, Indiana 46507) and describe the nature of the manufacturing defect. SPECIFIC LIMITATIONS: This warranty covers only the part(s) or product; any labor charges associated with repair or replacement of non-conformances are specifically excluded. Due to the corrosive nature of most fertilizers and ice melt products, EarthWay Products, Inc. makes no warranty against and specifically excludes part(s) or product degradation or failure due to corrosion or its effects. Clean and dry your spreader thoroughly after each use, as a preventative measure, coat all metal parts with a light oil or silicon spray.